

ANTI-VANDALpush button

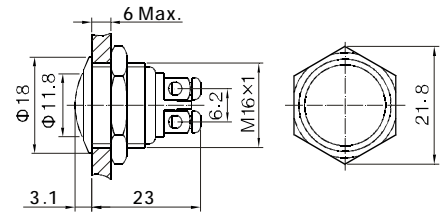

GQ16B

- ⊙ Φ 16mm diameter
- ⊙ Switch Rating:2A/36VDC
- ⊙ Contact Configuration:1NO(1NC Made to order)
- ⊙ Operation Type: Momentary
- ⊙ The Front Shape:Domed
- ⊙ The crust material: Stainless Steel/
Brass(Nickel plated, Gold plated)
- ⊙ IP Degree:IP65



ANTI-VANDALpush button



GQ16F

- ⊙ Φ 16mm diameter
- ⊙ Switch Rating:2A/36VDC
- ⊙ Contact Configuration:1NO(1NC Made to order)
- ⊙ Operation Type: Momentary
- ⊙ The Front Shape:Flat Round
- ⊙ The crust material: Stainless Steel/
Brass(Nickel plated, Gold plated)
- ⊙ IP Degree:IP65

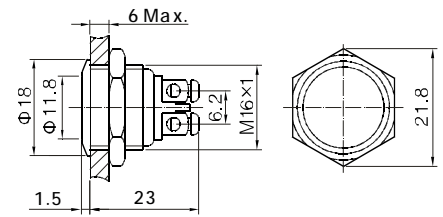

Specification	GQ16B - 10/⊙	GQ16F - 10/⊙
The Front Shape	Domed	Flat Round
Terminal Type	Screw Terminals	Screw Terminals
Switching	No.1	No.1
Max.Switch Rating	2A/36VDC	2A/36VDC
Contact Resistance	$\leq 50m\Omega$	$\leq 50m\Omega$
Insulation Resistance	$\geq 1000M\Omega$	$\geq 1000M\Omega$
Dielectric Strength	2000VAC	2000VAC
Operating Temp	-20°C ~ +55°C	-20°C ~ +55°C
Mechanical life	1,000,000 cycles	1,000,000 cycles
Electrical life	200,000 cycles	200,000 cycles
Panel Thickness	1 ~ 6mm	1 ~ 6mm
Torque	5 ~ 14Nm	5 ~ 14Nm
Operation Pressure	About 4N	About 4N
Operation Distance	About 1.5mm	About 1.5mm
IP Degree	IP65	IP65
Material	Contact	Silver Alloy
	Button	Stainless Steel/Brass(Nickel plated, Gold plated)
	Body	Stainless Steel/Brass(Nickel plated, Gold plated)
	Base	PBT
	RoHS	Made to order
		Made to order